

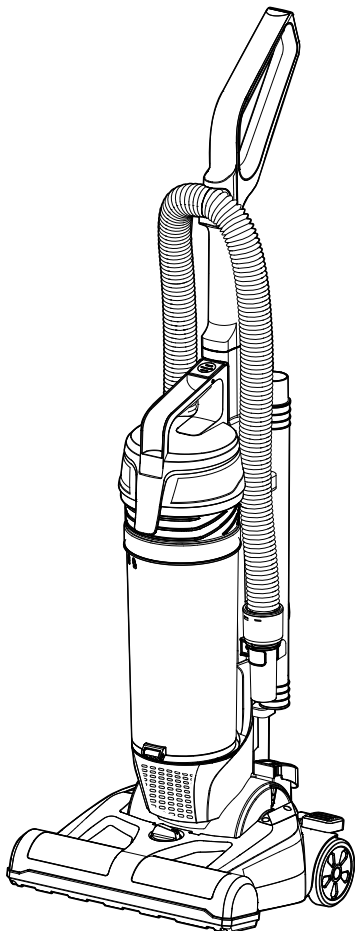

Master any mess.

Use & Care Guide



Bagless Upright Vacuum Cleaner

MODEL NO. UC0101



www.vacmaster.com
Cleva North America, Inc.
Greenville, SC 29607
(866) 384-8432
Made in China

TABLE OF CONTENTS

SECTION	PAGE
Important Safety Instructions.....	3
Warranty.....	4
Technical Data.....	4
Getting To Know Your Vacuum.....	5
General Assembly Instructions.....	7
Operating Instructions.....	11
Maintaining Your Vacuum.....	17
Troubleshooting.....	27

Thank you for purchasing this Vacmaster® vacuum cleaner. With it you are obtaining a high quality product that is engineered for optimal performance.

FOR YOUR SAFETY

Read and understand this manual before use.

Keep this manual and your sales check (receipt) in a safe place for future reference.

IMPORTANT SAFETY INSTRUCTIONS

When using an electrical appliance, basic precautions should always be followed, including the following:

READ ALL INSTRUCTIONS BEFORE USING THIS VACUUM CLEANER.

Failure to follow the warnings and instructions may result in electric shock, fire and/or serious injury.



WARNING—To reduce the risk of fire, electric shock, or injury:

- Do not leave appliance when plugged in. Unplug from outlet when not in use and before servicing.
- Do not use outdoors or on wet surfaces.
- Do not allow to be used as a toy. Close attention is necessary when used by or near children.
- Use only as described in this manual. Use only manufacturer's recommended attachments.
- Do not use with damaged cord or plug. If appliance is not working as it should, has been dropped, damaged, left outdoors, or dropped into water, return it to a service center.
- Do not pull or carry by cord, use cord as a handle, close a door on cord, or pull cord around sharp edges or corners. Do not run appliance over cord. Keep cord away from heated surfaces.
- Do not unplug by pulling on cord. To unplug, grasp the plug, not the cord.
- Do not handle plug or appliance with wet hands.
- Do not put any object into openings. Do not use with any opening blocked; keep free of dust, lint, hair, and anything that may reduce air flow.
- Keep hair, loose clothing, fingers, and all parts of body away from openings and moving parts.
- Turn off all controls before unplugging.
- Use extra care when cleaning on stairs.
- Do not use to pick up flammable or combustible liquids, such as gasoline, or use in areas where they may be present.
- Do not pick up anything that is burning or smoking, such as cigarettes, matches, or hot ashes.
- Do not use without filters in place.

SAVE THESE INSTRUCTIONS

Household use only

WARRANTY

FOR ONE YEAR from the date of sale, this product is warranted against defects in material or workmanship when it is assembled, operated and maintained according to all supplied instructions.

WITH PROOF OF SALE, a defective appliance will be replaced free of charge. For warranty coverage details to obtain free replacement, visit the web page: www.vacmaster.com or call (866) 384-8432.

- This warranty does not cover filters or belt, which are expendable parts that can wear out from normal use within the warranty period.
- This warranty is void if this product is ever used for other than private household purposes.
- This warranty gives you specific legal rights, and you may also have other rights which vary from state to state.

TECHNICAL DATA

Bagless Upright Vacuum Cleaner

Model: UC0101

Rated Voltage: 120V AC

Rated Frequency: 60Hz

Nominal Current: 10A

GETTING TO KNOW YOUR VACUUM

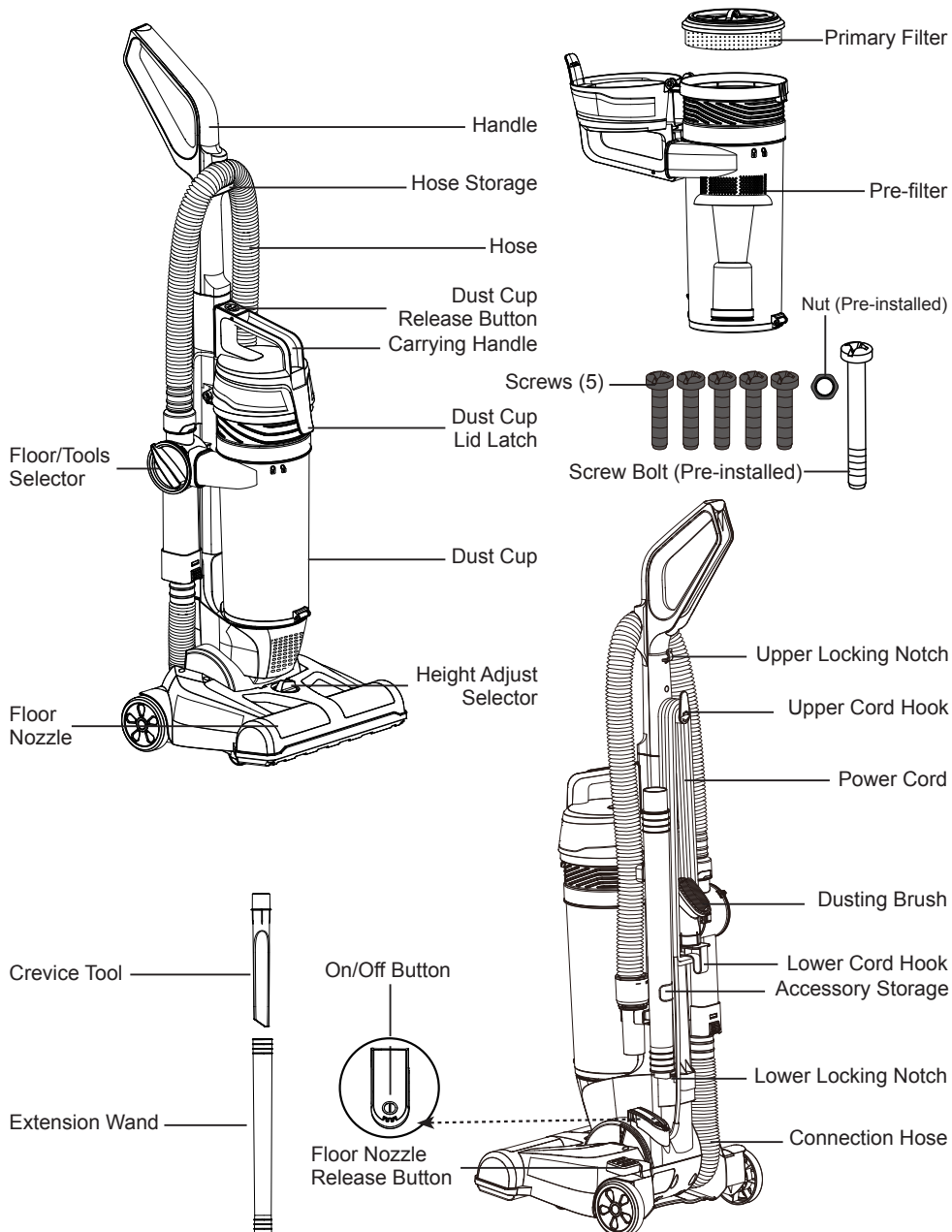

Replacement Parts

Item	Part No.
Primary Filter	571003122
Belt	571003165
Crevice Tool	571003111
Dusting Brush	571003112
Extension Wand	571003110
Hose	571003109
Screws (5)	571003116
Screw Bolt	571003114
Nut	571003106

Available online at www.vacmaster.com or call (866) 384-8432.

GENERAL ASSEMBLY INSTRUCTIONS

Assembly Instructions

1. Insert the main body into the floor nozzle and secure with screws provided.
Insert four screws into the front of the main body, and insert one screw into the back of the main body.

Note: Make sure all screws are installed into place correctly. If the screws are not installed or not fully tightened, this may impact the performance of the vacuum cleaner and may cause personal injury or damage. Do not over-tighten the screws.

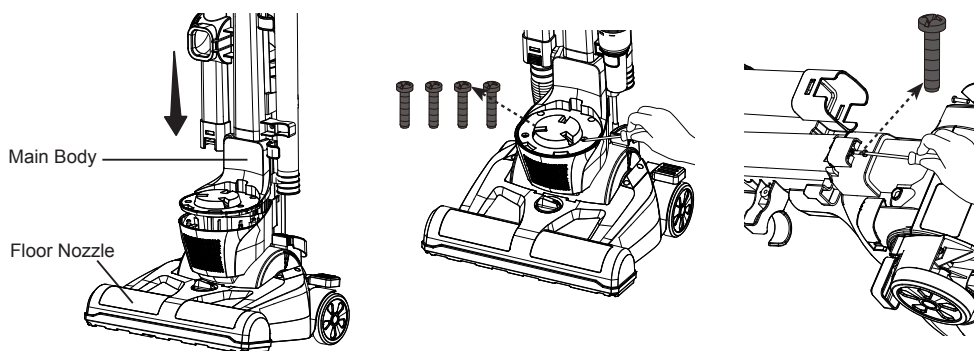

2. Insert the connection hose into the main body until you hear a click.

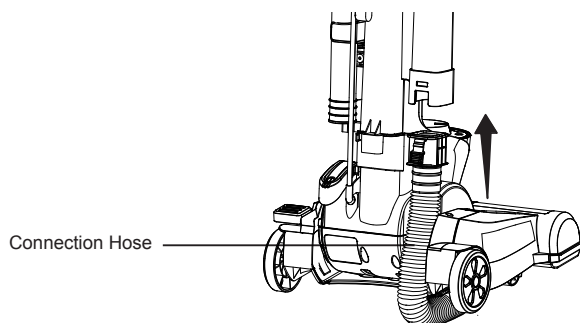

3. There is a screw bolt and nut pre-installed into the top of the main body. You need to remove the bolt before installing the handle into the main body.

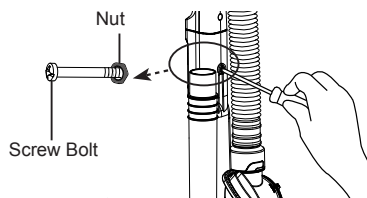

4. Insert the handle into the main body and secure with one screw bolt provided.

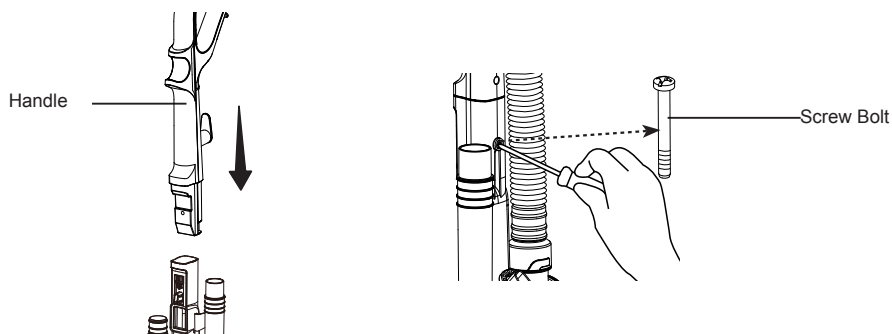

5. Install the hose into the main body. Insert the other end of the hose into the hose storage and fix into place.

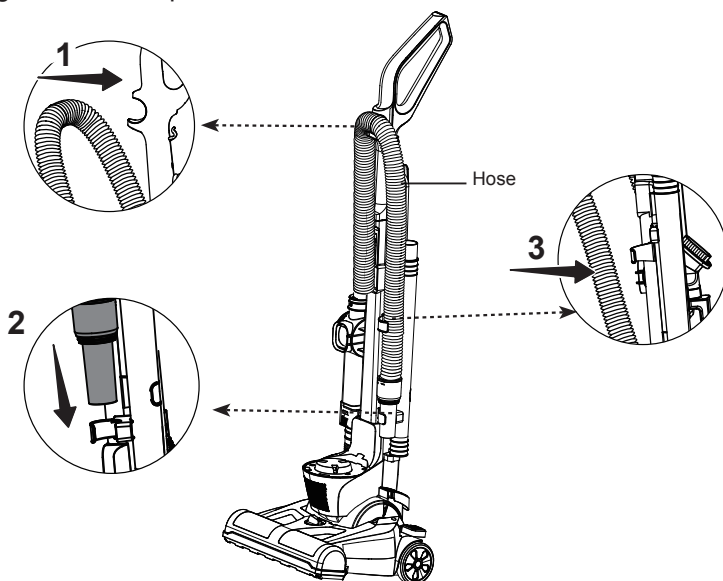

6. Insert the dust cup into the slots on the bottom of the main body, then press the dust cup into locked slot and click into place.

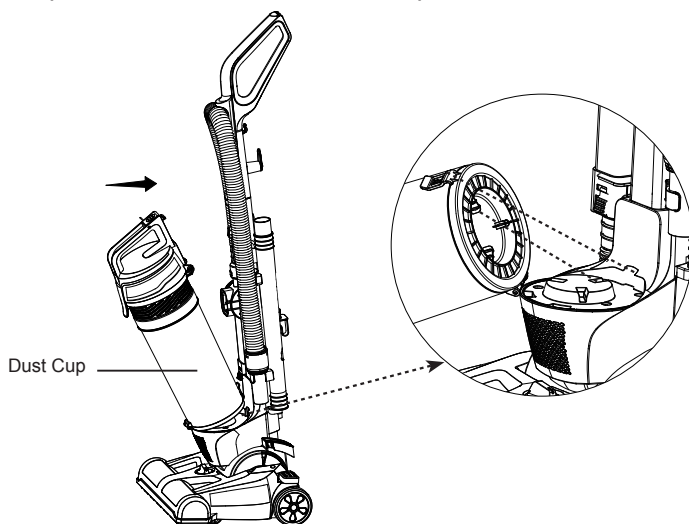

7. Insert the dusting brush onto the accessory storage located on the back of the main body. Make sure the extension wand is inserted into the accessory storages located on the side of the main body as shown. Note, the crevice tool fits inside the extension wand for storage convenience.

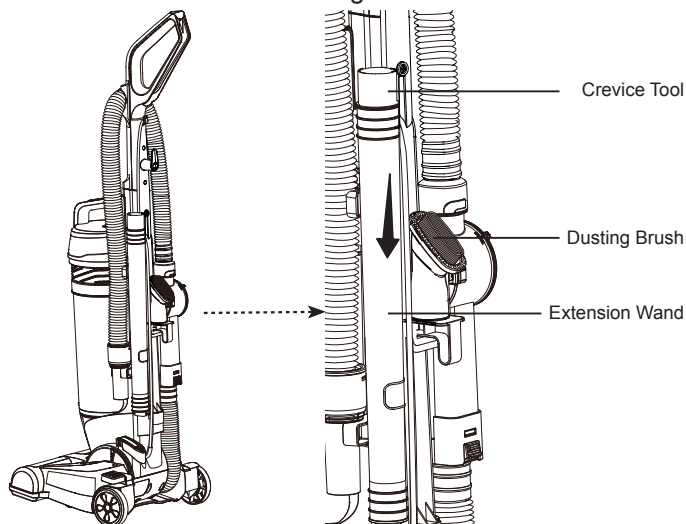

8. Make sure the upper cord hook is in the upright position as shown. Wrap the power cord loosely around the upper and lower cord hooks.

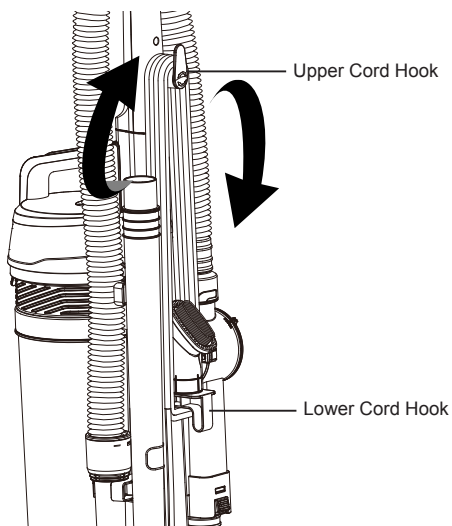

9. Lock power cord plug onto the power cord.

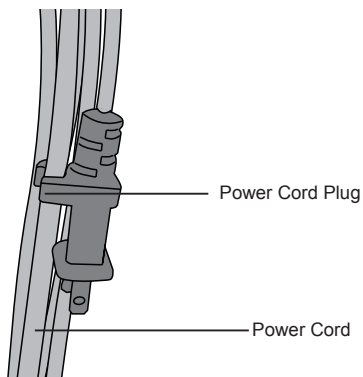

WARNING

Wrapping the cord too tightly with excessive stress on the cord may cause cord damage. A damaged cord is an electrical shock hazard and could cause personal injury or damage.

OPERATING INSTRUCTIONS

Using Your Upright Vacuum Cleaner

Note: Make sure the vacuum cleaner is completely assembled and the dust cup is empty before using. Do not operate vacuum cleaner without filters in place.

1. Turn the upper cord hook to either side to release the power cord.

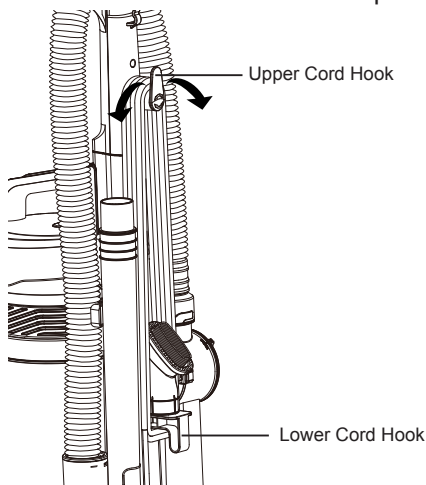

2. Detach the power cord plug from the power cord.
3. Be sure the power cord is locked into the upper locking notch and the lower locking notch as shown. This will help manage the power cord when operating the vacuum cleaner.

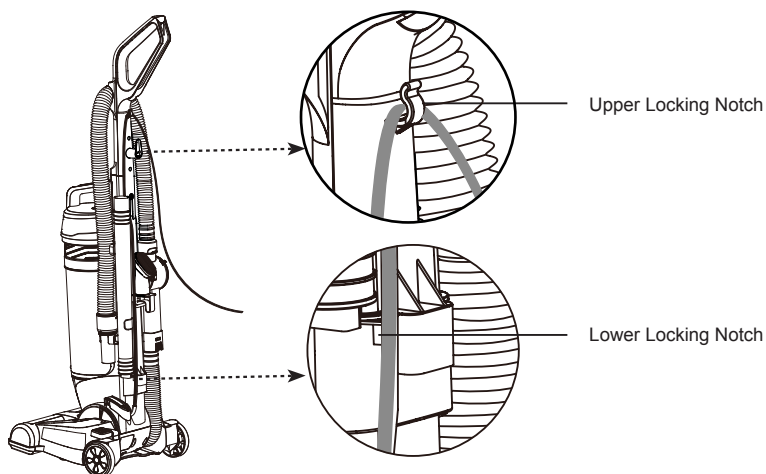

Note: Lock the power cord into the lower locking notch first and then lock it into the upper locking notch to avoid damaging the power cord.

4. Plug the power cord plug into an outlet located near the floor.

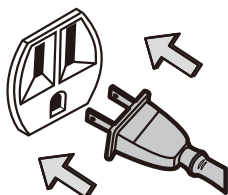

WARNING

To reduce the risk of electric shock, this appliance has a polarized plug (one blade is wider than the other). This plug will fit in a polarized outlet only one way. If the plug does not fit fully in the outlet, reverse the plug. If it still does not fit, contact a qualified electrician to install the proper outlet. Do not change the plug in any way.

5. When vacuuming floors, verify that the floor/tools selector is in the “FLOOR” position.

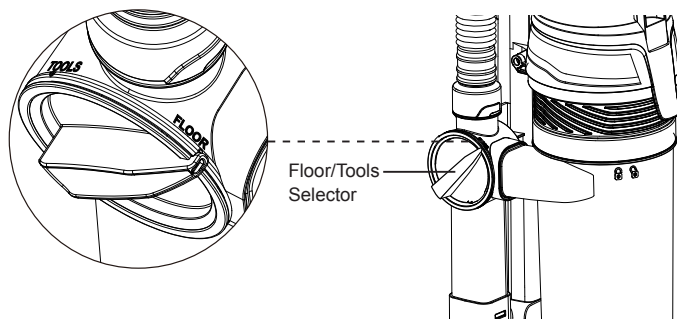

6. Release the floor nozzle by placing foot on the floor nozzle release button and pulling back on handle to change the handle position.

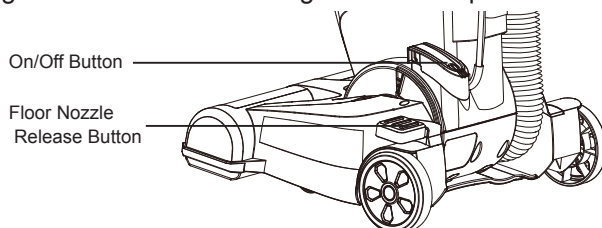

7. Press the on/off button to turn the vacuum cleaner on.
8. Once you have completed vacuuming, press the on/off button, return the handle to the upright position and unplug the power cord plug from the outlet.

Pile Height Selection and Settings

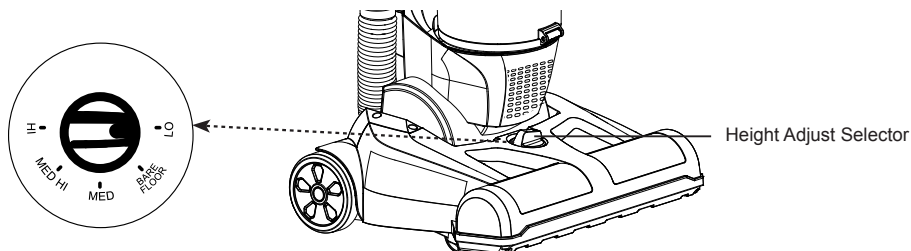

Select a pile height setting by turning the height adjust selector located on the floor nozzle.

Suggested Pile Height Settings

There are five (5) pile height settings on the vacuum cleaner. For best deep down cleaning of low pile carpet, use the LO setting. However, you may need to raise the height to make some jobs easier, such as scatter rugs and some deep pile carpets.

Suggested settings are:

LO – Low pile carpet

BARE FLOOR – Bare floor

MED – Medium pile carpet

MED HI – Medium to deep pile

HI – Shag, deep pile, or scatter rugs



CAUTION

Incorrect setting may damage floor.



CAUTION

Do not allow the vacuum cleaner to remain in one spot for any length of time when the brush roll is turning. Damage to carpet may occur.

CAUTION

Moving parts! To reduce the risk of personal injury, **DO NOT** touch the brush roll in the floor nozzle when the vacuum is on. Contacting the brush roll while it is rotating can cause injuries. Always turn off before performing maintenance or servicing. Use caution when operating near children.

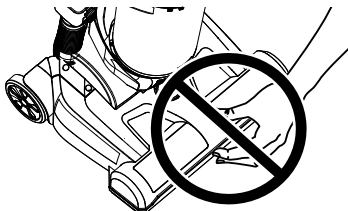

Using Your Vacuum Cleaner with Accessories

1. Place vacuum cleaner in the upright locked position.
2. Rotate the floor/tools selector from the “FLOOR” position to the “TOOLS” position until you hear a click.

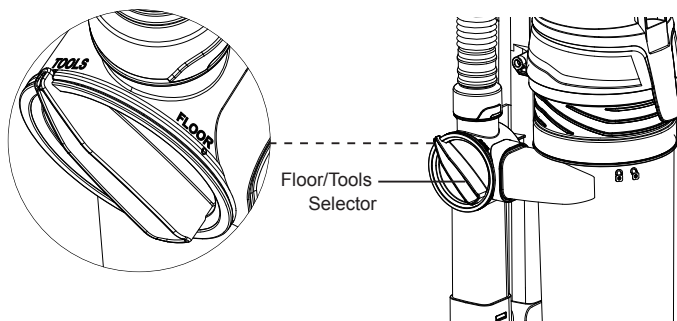

3. Release the hose from the main body.

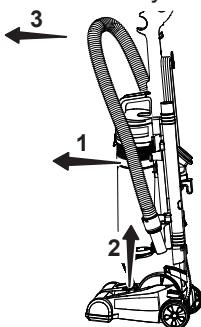

4. Insert the hose into the smaller end of the extension wand.

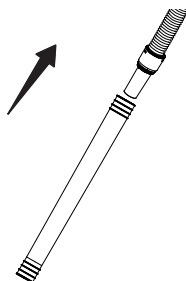

5. Choose the desired accessories and insert into the larger end of the extension wand.

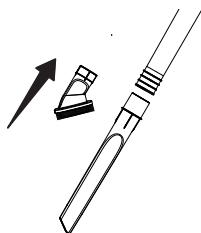

Note: You can also choose to use your vacuum cleaner by inserting the crevice tool or the dusting brush directly into the hose.

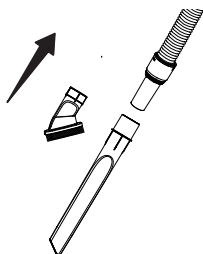

6. Plug the power cord plug into an outlet located near the floor.

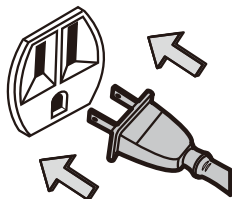

7. Press the on/off button to turn the vacuum cleaner on.

8. Once you have completed vacuuming, press the on/off button, return the handle to the upright position and unplug the power cord plug from the outlet.

Note: Remember to rotate the floor/tools selector back to the “FLOOR” position for standard vacuuming sessions.



CAUTION

When using accessories, be careful not to overextend the hose when reaching to avoid tipping the vacuum over.



CAUTION

DO NOT pull the vacuum cleaner around the room by the hose. Property damage or personal injury could result.

Storing Your Vacuum

1. Ensure the hose is locked into place and the accessories are stored on-board.
2. Gather the cord and wrap it loosely around the upper and lower cord hooks. Lock the power cord plug onto the power cord.
3. Store the vacuum cleaner in a dry, indoor area, on the floor with the handle locked in the upright position.

MAINTAINING YOUR VACUUM

CAUTION

To reduce the risk of shock, disconnect the power cord and turn off before performing any service or maintenance.

Note: Use dry cloth to clean the outside of the unit. Do not allow any kind of liquid to enter the unit. Wash the extension wand, crevice tool, and the dusting brush in warm soapy water, rinse and air dry. Do not clean in dishwasher.

Emptying the Dust Cup

Note: For best performance, empty dust cup after every use. Never operate vacuum cleaner without dust cup and filters in place.

1. Press the dust cup release button to remove the dust cup from the main body.

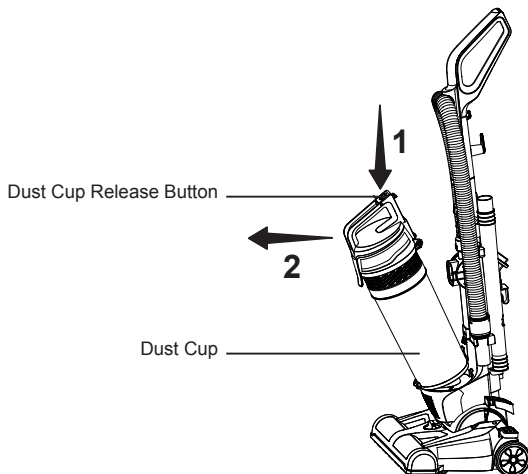

2. Remove any clogs that might be located in the suction port or filter port area.

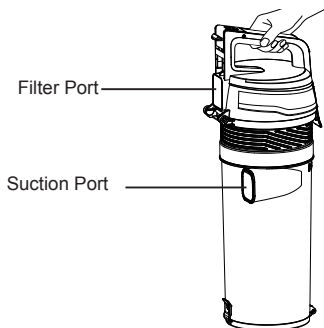

3. Position dust cup area of vacuum over a waste receptacle. Press down on the dust release latch to open dust cup lid and allow contents to drop into waste receptacle.

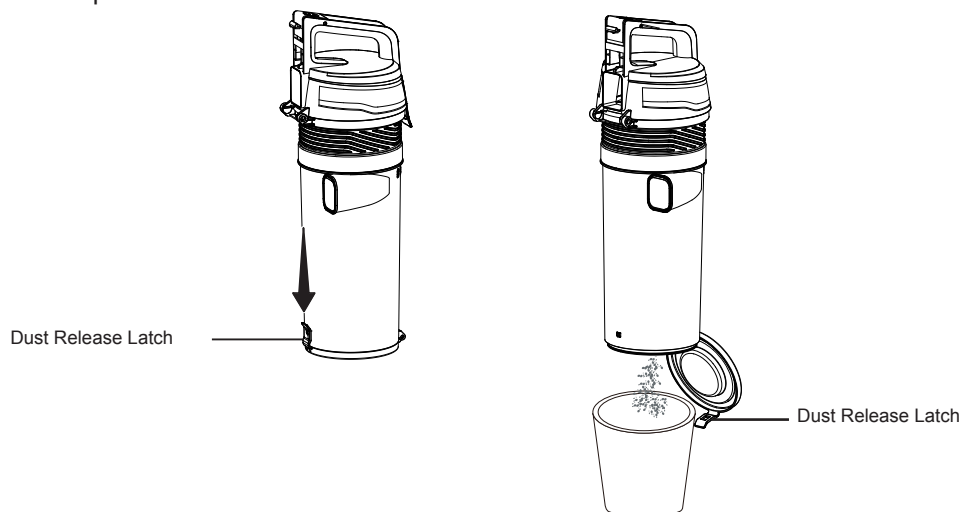

4. Shake the dust cup to release any debris that might hang in the pre-filter.
5. Reinstall and insert the dust cup into the slots on the bottom of the main body, then press the dust cup into locked slot and click into place.

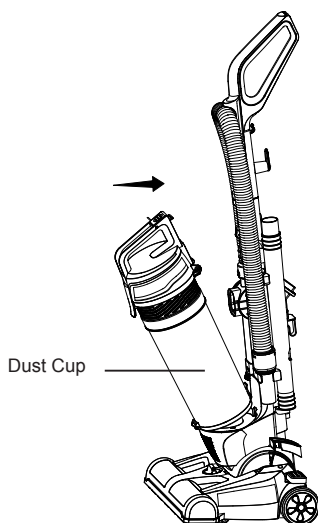

Cleaning the Pre-Filter

The pre-filter is located inside the dust cup. Check the pre-filter frequently and clean when dirty.

NOTE: Make sure the dust cup is free of any debris before opening.

1. Remove the dust cup as outlined in the **Emptying the Dust Cup**.
2. Rotate the dust cup lid assembly counterclockwise until marks align to the unlocked position as shown below.

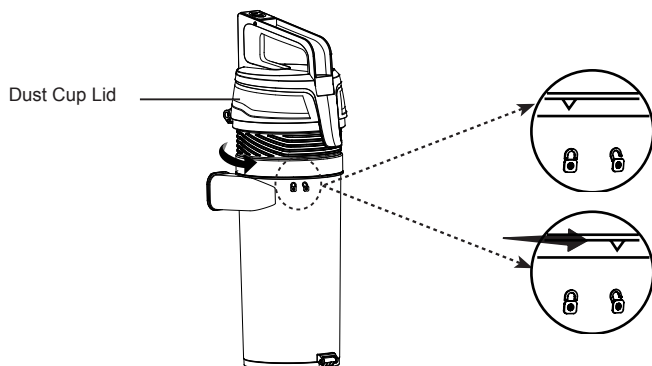

3. Clean off hair and other debris wrapped around the pre-filter. Clean the pre-filter by gently tapping over a trash container. Tap on several sides to ensure best cleaning.

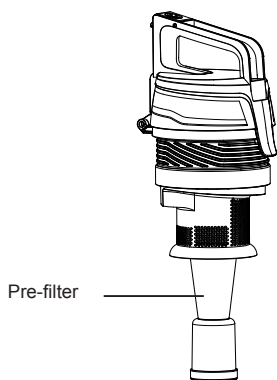

4. If necessary, rinse the pre-filter with cold water only. Do not use detergent or soap. Set the pre-filter aside and allow to air dry for 24 hours.
Do not wash in the dishwasher. Do not install damp.

IMPORTANT: The filters must dry completely before reuse.

5. Reinstall the lower portion of the dust cup by aligning marks to the locked position as shown below.

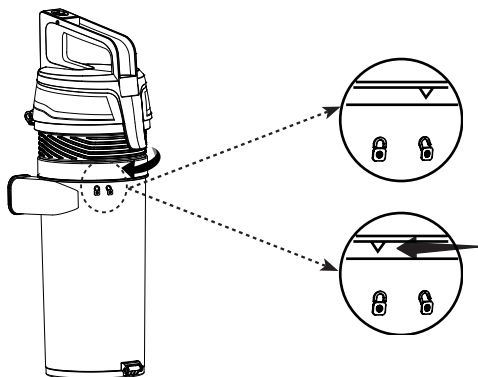

6. Rotate the dust cup lid assembly clockwise until marks align as shown above in **LOCKED**.
7. Reinstall the dust cup into the main body. See installation instructions in the **Emptying the Dust Cup**.

Cleaning the Primary Filter

The primary filter is located inside the dust cup lid.

It is recommended to clean the primary filter with cold water at least once a month. Check the primary filter frequently and clean when dirty.

1. Remove the dust cup as outlined in the **Emptying the Dust Cup**.
2. Pull the dust cup lid latch and open the lid.

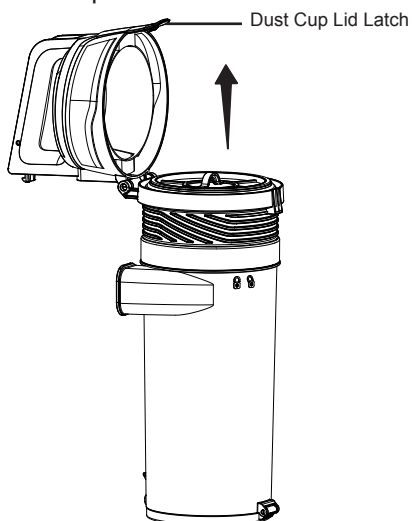

3. Remove the primary filter cover with the primary filter from the dust cup.

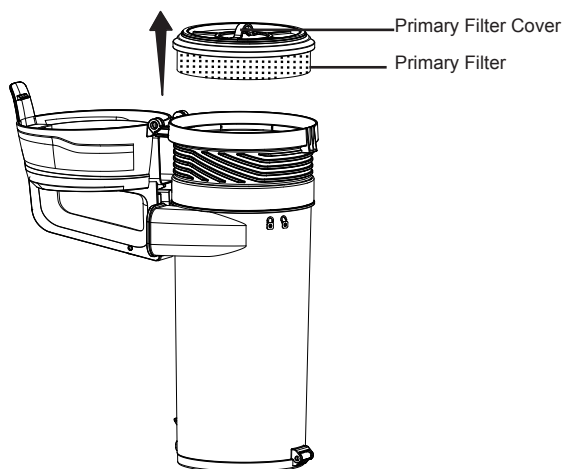

4. Separate the primary filter from the primary filter cover.

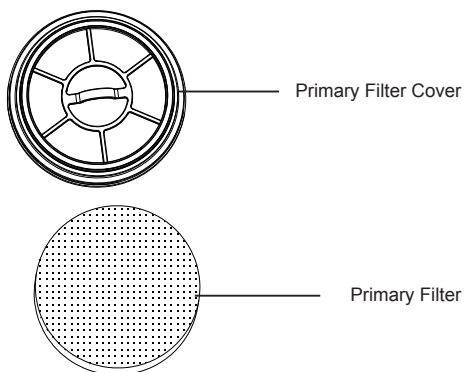

5. Use a soft brush to brush loose debris from the primary filter then rinse with cold water. Rinse and gently squeeze dry the primary filter. Set it aside and allow to air dry for 24 hours.

IMPORTANT: The filters must dry completely before reuse.

6. Place the primary filter back into the primary filter cover.
7. Place the primary filter cover with the primary filter back into the dust cup lid.

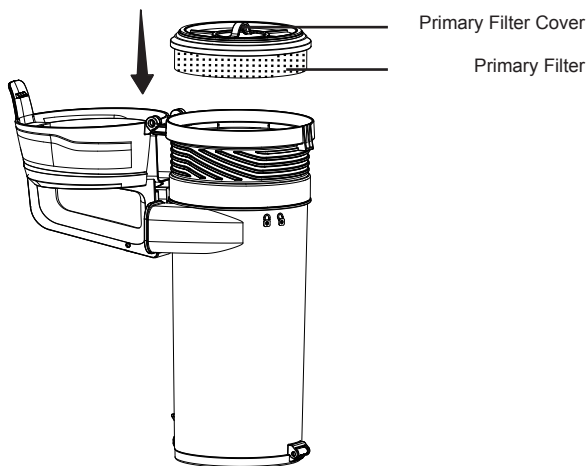

8. Close the dust cup lid until you hear a click.

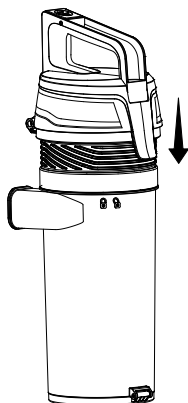

9. Reinstall the dust cup into the main body. See installation instructions in the **Emptying the Dust Cup**.

Changing the Belt

Replace the belt whenever a burning rubber smell caused by excessive slippage occurs.



WARNING

Always unplug the power cord from an electrical outlet before performing maintenance to the vacuum cleaner.

1. Lay vacuum cleaner on floor with the bottom up and the floor nozzle flat.
2. Remove five screws from the lower plate. Then remove the lower plate from the floor nozzle.

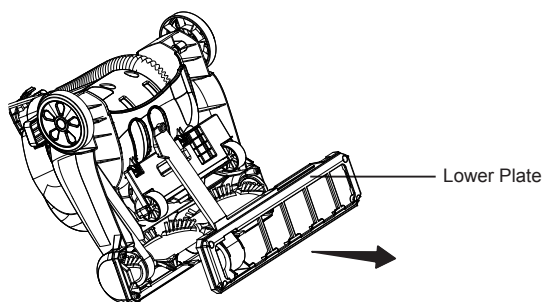

3. Remove the brush roll by carefully lifting out.

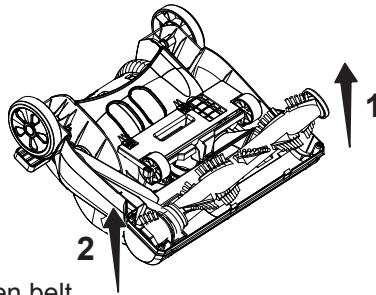

4. Remove the worn or broken belt.

5. Use scissors to remove any entangled hair around the brush roll. Clean any debris from the floor nozzle.

6. Loop the new belt around motor shaft and the brush roll.

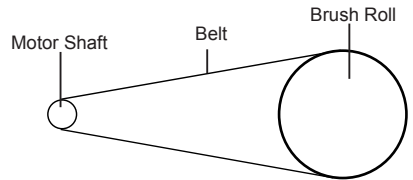
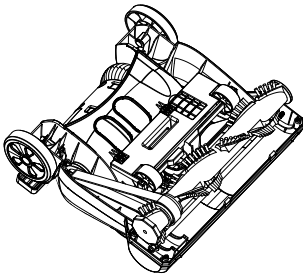

7. Reinstall the brush roll back into the floor nozzle. Place the end cap with the belt into groove first, and then place the other end cap into the other groove as shown below. Rotate the brush roll to make sure the belt is installed correctly.

Note: Make sure the belt is in the middle of the slot as illustrated in the below picture.

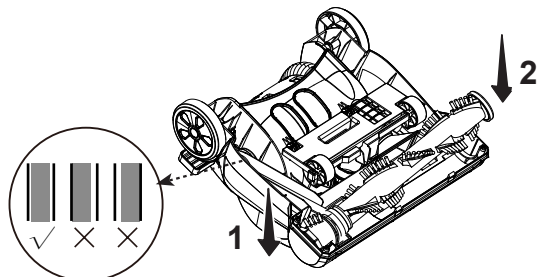
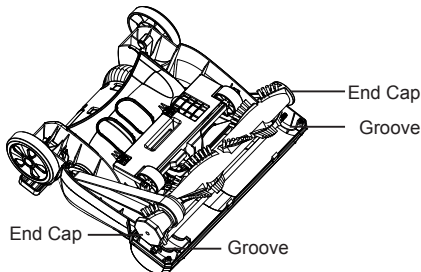

8. Reinstall the lower plate by aligning tabs on front edge of lower plate with slots in the nozzle first, and then press the lower plate into installed position.

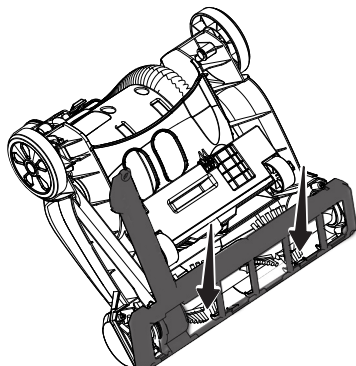

9. Reinstall five screws into the lower plate. Do not over-tighten the screws.

Cleaning the Brush Roll



WARNING

Always unplug the power cord from an electrical outlet before performing maintenance to the vacuum cleaner.

To maintain efficient cleaning, the brush roll must be kept free of carpet fiber, string, or hair build-up. When it is dirty, unplug and turn vacuum cleaner off and check the brush roll for fiber and hair build-up.

Use scissors to remove any build-up entangled around the brush roll.

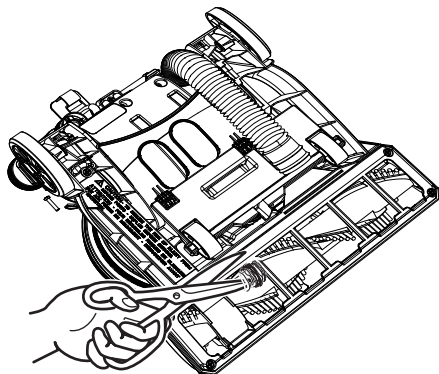

Removing Clogs

1. Remove any accessories from the end of hose.
2. Remove the hose end from the main body by turning counterclockwise.

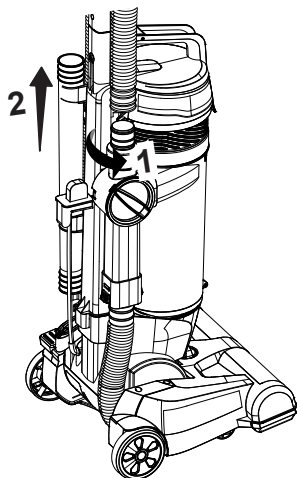

3. Check and remove any clogs in the hose.
4. Press the two release buttons, and pull the connection hose away from the main body.

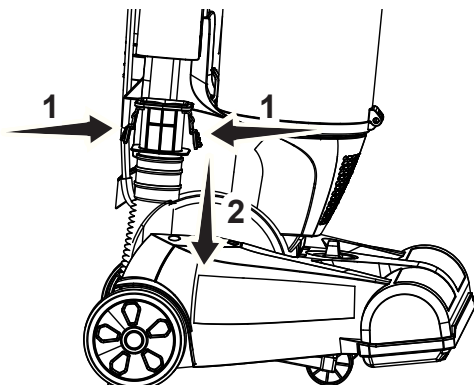

5. Check and remove any clogs in the connection hose.

TROUBLESHOOTING

Should you have any problem(s) with your vacuum cleaner, review the table below for solutions to minor performance issues.



WARNING

Disconnect electrical supply before performing maintenance to the vacuum cleaner. Failure to do so could result in electrical shock or personal injury.

PROBLEM	POSSIBLE CAUSE	SOLUTION
Vacuum will not power on.	The plug is not plugged to the wall outlet.	Be sure power cord plug is fully plugged into outlet.
	The On/Off button is not pressed to start the vacuum cleaner.	Press the on/off switch to start the vacuum cleaner.
	The vacuum body is overheated.	Unplug the power cord and let the vacuum cool down for 50 minutes.
	The motor is damaged.	Call (866) 384-8432 for assistance.
The job of dirt pick-up is poor or suction power is weak.	Dust cup is full or clogged.	Empty the dust cup.
	The primary filter or the pre-filter needs cleaning.	Follow filter cleaning instructions on page 19 or 20.
	The brush roll is worn.	Call (866) 384-8432 for assistance.
	The belt is worn or broken.	Replace the belt. Purchase online at www.vacmaster.com or call (866) 384-8432.
	The hose is worn.	Replace the hose. Purchase online at www.vacmaster.com or call (866) 384-8432.
	The primary filter needs to be replaced.	Purchase online at www.vacmaster.com or call (866) 384-8432.
	There is a clog in the hose or connection hose of the vacuum cleaner.	Check and remove all clogs. Follow instructions on page 26.

The job of dirt pick-up is poor or suction power is weak.	Dust cup is not installed well.	Check dust cup for correct installation and ensure it is snapped firmly in place.
	The hose and accessories are not installed well.	Check the hose and accessories for correct installation and ensure they are snapped firmly in place.
	The floor/tools selector is in the wrong position or not clicked into place.	Check and place the floor/tools selector into the correct position. Follow instructions on page 12 or 14.
Dust escapes from vacuum.	The primary filter is missing or installed incorrectly.	Check filter for correct installation. Follow instructions on page 19.
	The primary filter is damaged and needs to be replaced.	Replace the primary filter. Purchase online at www.vacmaster.com or call (866) 384-8432.
	The pre-filter is damaged.	Call (866) 384-8432 for assistance.
	Dust cup is installed incorrectly.	Position dust cup correctly and snap firmly into place.
Brush roll in the floor nozzle is not turning.	Brush roll is jammed.	Remove obstruction. Follow instructions on page 25.
	Brush roll is not installed well.	Remove brush roll and reinstall following instructions on page 24.
	The belt is worn or broken.	Replace the belt. Purchase online at www.vacmaster.com or call (866) 384-8432.
	The belt is not routed correctly.	Check the belt routing on page 23.

Airflow restricted with accessories in use; sound changes.	There are obstructions in the accessory tools restricting air flow.	Check accessories for fuzz lint, pet hair or other debris.
	There is an obstruction in the hose that has clogged the air path.	Check for and remove any clogs and clean the hose. Follow instructions on page 26.

For further questions, call our support team at (866) 384-8432.