



Ash Vacuum

## Operator's Manual



**6 Gallon**  
Model No.  
**EATC608S**

### **FOR YOUR SAFETY**

Read and understand this manual before use.  
Keep this manual for future reference.



Distributed By  
Cleva North America, Inc.  
601 Regent Park Court  
Greenville, SC 29607

Replacement Filters &  
Accessories available at:  
**Vacmaster.com**

# TABLE OF CONTENTS

SECTION	PAGE
Warranty.....	2
Important Safety Instructions.....	3-4
Double Insulation Instructions.....	5
Extension Cords.....	6
Symbols.....	6
Getting To Know Your Ash Vacuum.....	7
General Assembly Instructions.....	8
LED Work Light Use.....	9
Ash Vacuum Operation.....	10
Blower Operation.....	11
Maintenance.....	12
Troubleshooting.....	13
Exploded View.....	14
Parts List.....	15

**Thank you for purchasing this Vacmaster® Ash vacuum cleaner. Feel confident that with Vacmaster® you are obtaining a high quality product engineered for optimal performance. This vacuum is capable of picking up dry materials.**

**FOR YOUR SAFETY: CAREFULLY READ AND UNDERSTAND ALL INSTRUCTIONS.**

## WARRANTY

We take pride in producing a high quality, durable product. This Vacmaster® product carries a limited two (2) year warranty against defects in workmanship and materials from date of purchase under normal household use. If product is to be used for commercial, industrial, or rental use, a 90 day limited warranty will apply. Please keep your receipt as proof of purchase. This warranty gives you specific legal rights, and you may have other rights, which may vary from state to state. For product service call Customer Service at 1-866-384-8432.

### **Not Covered by Warranty:**

- Any part that has become inoperative due to misuse, negligence, direct/indirect abuse, accidents, improper maintenance, repairs, or alterations;
- Consumables such as filters and accessories;
- Normal wear and tear of parts and attachments, such as hose, nozzles, or casters;
- Normal deterioration of the exterior finish due to use or exposure;
- Any product where serial number/data label is tampered with or removed;
- Any product purchased from an unauthorized retailer.

# IMPORTANT SAFETY INSTRUCTIONS

## READ AND UNDERSTAND ALL INSTRUCTIONS BEFORE USING THIS VACUUM

Read and understand this operator's manual and all labels on the Ash Vacuum cleaner before operating. Safety is a combination of common sense, staying alert and knowing how your vacuum works. Use this Ash Vacuum only as described in this manual. To reduce the risk of personal injury or damage to your Ash Vacuum, use only manufacturer recommended accessories.  
For Household Use Only.

## SAVE THIS MANUAL FOR FUTURE REFERENCE.

This vacuum is intended for removing loose, cool ash from the ash collection areas of stoves and fireplaces. Do not vacuum soot. Soot is a combustible material generally found in deposits along exhaust areas and chimneys.

The temperature of the vacuuming material must be below 100°F (40°C). If it exceeds 100°F (40°C), there is a risk of fire.



**CAUTION: NEVER USE THIS PRODUCT FOR VACUUMING LIQUIDS. ONLY USE THIS UNIT TO VACUUM DRY DUST MATERIAL!**

When using a vacuum, basic precautions should always be followed including the following:



**WARNING: TO REDUCE THE RISK OF FIRE, ELECTRIC SHOCK OR INJURY:**

- Do not run vacuum unattended.
- Do not use to pick up flammable or combustible liquids, such as gasoline, or use in areas where they may be present.
- Do not vacuum, or use this ash vacuum near flammable liquids, gases, or explosive vapors like gasoline or other fuels, lighter fluids, cleaners, oil-based paints, natural gas, hydrogen, or explosive dusts like coal dust, magnesium dust, grain dust, or gun powder. Sparks inside the motor can ignite flammable vapors or dust.
- To reduce the risk of health hazards from vapors or dusts, do not vacuum toxic materials.
- Do not use or store near hazardous materials.
- Do not vacuum anything that is burning or smoking, such as cigarettes, matches, or hot ashes.
- Do not expose to rain. Store indoors.
- If ash vacuum is not working as it should, has been dropped, damaged, left outdoors, or dropped into water, return it to a service center.
- Do not unplug by pulling on cord. To unplug, grasp the plug, not the cord.
- Do not use with damaged cord or plug.
- Do not pull or carry by cord, use cord as a handle, close a door on cord, or pull cord around sharp edges or corners.
- Keep cord away from heated surfaces.
- Do not run ash vacuum over cord.
- Do not handle plug or ash vacuum with wet hands.
- Do not use this vacuum with a torn filter or without the filter installed.
- Do not allow to be used as a toy. Close attention is necessary when used by or near children, pets or plants.
- To reduce the risk of injury from accidental starting, unplug power cord before changing or cleaning filter.
- Do not leave ash vacuum when plugged in. Unplug from outlet when not in use and before servicing.

- Turn off all controls before unplugging.
  - Do not put any object into openings. Do not use with any opening blocked; keep free of dust, lint, hair, and anything that may reduce air flow.
  - Keep hair, loose clothing, fingers, and all parts of body away from openings and moving parts.
  - Use extra care when cleaning on stairs.
  - Use only as described in this manual. Use only manufacturer's recommended attachments.
  - The use of the vacuum can result in foreign objects being blown into eyes. Always wear safety goggles complying with ANSI Z87.1 (or in Canada CSAZ94.3) when operating vacuum.
  - This ash vacuum is provided with double insulation. Use only identical replacement parts.
- See **DOUBLE INSULATION INSTRUCTIONS**.

**ATTENTION:** Vacuuming materials, which appear to have cooled down, may still be very hot inside. Hot ash particles may ignite with airflow. Wait until the fire is extinguished and the ashes have cooled down before you begin cleaning. It is not recommend to quickly extinguish the fire with water. Please make sure that ashes are cold before you vacuum. Temperature exceeding 100°F (40°C) may damage the vacuum cleaner and the components included. Continuously check hose, ash filter, and vacuum cleaner for excessive temperatures during operation. If you notice a temperature rise, switch off the vacuum cleaner immediately and disconnect it from the power outlet. Take the vacuum outside and remove the power head.



**CAUTION: IN CASE OF EXCESSIVE TEMPERATURE, THE HOSE, FILTER, OR VACUUM CLEANER MAY BE DAMAGED. COMPLETELY EMPTY THE VACUUM CLEANER AND BRUSH OFF THE ASH FILTER IN A SAFE, WELL VENTILATED AREA AFTER VACUUMING. LET BOTH ITEMS (VACUUM CLEANER AND ASH FILTER) COOL DOWN UNDER SUPERVISION.**



**CAUTION: TO REDUCE THE RISK OF INJURY FROM MOVING PARTS - UNPLUG BEFORE SERVICING.**



**WARNING: TO REDUCE THE RISK OF ELECTRIC SHOCK - UNPLUG BEFORE CLEANING OR SERVICING.**

**When using as blower:**

- Direct air discharge only at work area.
- Do not use Ash Vacuum as a sprayer.
- Do not direct air at bystanders.
- Keep children away when blowing.
- Wear safety goggles.

## **SAVE THESE INSTRUCTIONS**

# DOUBLE INSULATION INSTRUCTIONS

This Ash Vacuum is double-insulated, eliminating the need for a separate grounding system. Use only identical replacement parts. Read the instructions for Servicing Double-Insulated Ash Vacuum before servicing. Use this Ash Vacuum as described in this manual.

Observe the following warnings that appear on the motor housing of your Ash Vac.



**DOUBLE INSULATED - GROUNDING NOT REQUIRED - WHEN SERVICING USE ONLY IDENTICAL REPLACEMENT PARTS.**



**WARNING: TO REDUCE THE RISK OF ELECTRIC SHOCK-DO NOT EXPOSE TO RAIN. STORE INDOORS.**



**WARNING: FOR YOUR OWN SAFETY, READ AND UNDERSTAND OPERATOR'S MANUAL. DO NOT RUN UNATTENDED. DO NOT PICK UP HOT ASHES, COALS, TOXIC, FLAMMABLE OR OTHER HAZARDOUS MATERIALS. DO NOT USE AROUND EXPLOSIVE LIQUIDS OR VAPORS.**



**WARNING: SERVICING OF DOUBLE-INSULATED ASH VACUUM**  
WITH A DOUBLE-INSULATED ASH VACUUM, TWO SYSTEMS OF INSULATION ARE PROVIDED INSTEAD OF GROUNDING. NO GROUNDING MEANS IS PROVIDED ON A DOUBLE-INSULATED APPLIANCE, NOR SHOULD A MEANS FOR GROUNDING BE ADDED. SERVICING A DOUBLE INSULATED ASH VACUUM REQUIRES EXTREME CARE AND KNOWLEDGE OF THE SYSTEM, AND SHOULD BE DONE ONLY BY QUALIFIED SERVICE PERSONNEL. REPLACEMENT PARTS FOR A DOUBLE-INSULATED ASH VACUUM MUST BE IDENTICAL TO THE PARTS THEY REPLACE. YOUR DOUBLE-INSULATED ASH VAC IS MARKED WITH THE WORDS 'DOUBLE INSULATED' AND THE SYMBOL  (SQUARE WITHIN A SQUARE) MAY ALSO BE MARKED ON THE APPLIANCE.



# EXTENSION CORDS

When using an extension cord with your Ash Vacuum refer to the following table to determine the required A.W.G. wire size. Before using the cleaner make sure the power cord and extension cord are in good working condition. Make repairs or replacements before using the vacuum cleaner. Only use extension cords that are rated for outdoor use.

		Length of Extension Cord			
120V		25ft (7.62m)	50ft (15.24m)	100ft (30.48m)	150ft (45.72m)
Ampere rating		A.W.G. Wire Size			
More than	Not more than				
0	6	18	16	16	14
6	10	18	16	14	12
10	12	16	16	14	12
12	16	14	12	Not recommended	

# SYMBOLS

The following signal words and meanings are intended to explain the levels of risk associated with this product.

SYMBOL	SIGNAL	MEANING
	<b>DANGER</b>	Indicates an imminently hazardous situation, which, if not avoided, will result in death or serious injury.
	<b>WARNING</b>	Indicates a potentially hazardous situation, which, if not avoided, could result in death or serious injury.
	<b>CAUTION</b>	Indicates a potentially hazardous situation, which, if not avoided, may result in minor or moderate injury.
	<b>NOTICE</b>	(Without Safety Alert Symbol) Indicates a situation that may result in property damage.

# GETTING TO KNOW YOUR ASH VACUUM

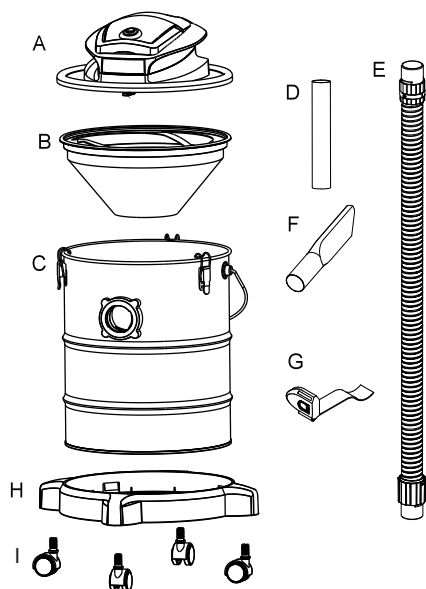

Remove all contents from the box. Remove the power head and take out any contents inside the collection tank. Check each item against the carton contents list.

Key	Description.....	Qty
A	Power Head.....	1
B	Ash Filter.....	1
C	Collection Tank.....	1
D	Aluminum Wand.....	1
E	Aluminum Hose.....	1
F	Aluminum Crevice Tool.....	1
G	LED Work Light.....	1
H	Base.....	1
I	Casters.....	4

**NOTE:** The hose and accessories for this ash vacuum are 1-1/2 inch (38.1mm) diameter.

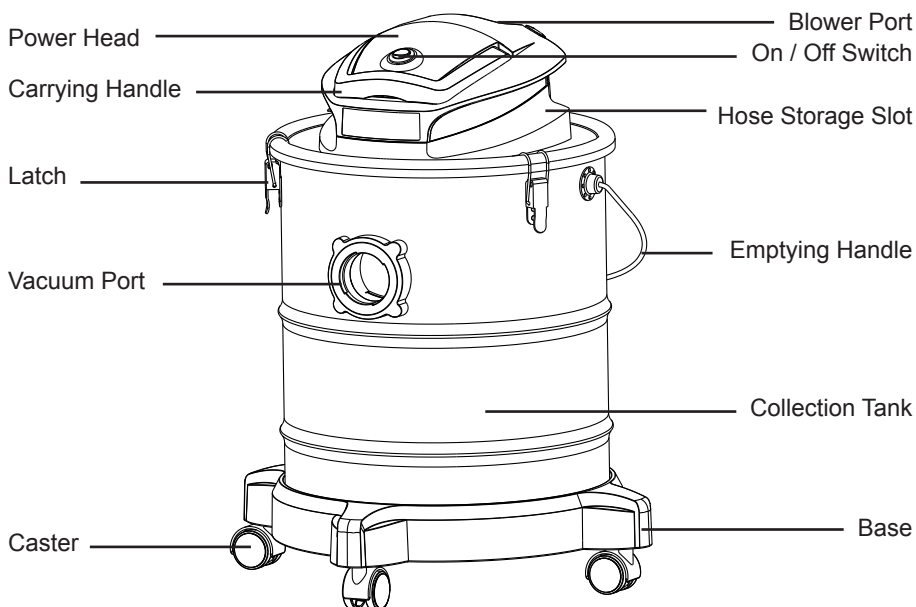

# GENERAL ASSEMBLY INSTRUCTIONS

**⚠ WARNING: DO NOT PLUG POWER CORD INTO POWER OUTLET. MAKE SURE PLUG IS DISCONNECTED BEFORE ASSEMBLING THE ASH VACUUM. TO REDUCE THE RISK OF ELECTRIC SHOCK, DO NOT EXPOSE TO RAIN.**

1. Remove the Ash Vacuum from the package.
2. Undo the latches and remove the power head lid (Fig. 1).
3. Remove the contents from inside the collection tank; make sure you have all the parts listed on page 7 (Fig. 2).
4. Turn the collection tank upside down, and insert the casters on to the four feet of the collection tank base. Ensure that they are mounted correctly and "snap" into place (Fig. 3).
5. Place the filter onto the rim of the collection tank. Make sure the edge of the filter fits snugly along the edge of the collection tank (Fig. 4).
6. With the filter installed, place the power head onto the collection tank and secure it with the latches (Fig. 5).
7. Insert the hose into the vacuum port and connect the metal intake nozzle into the other end of the hose (Fig. 6).

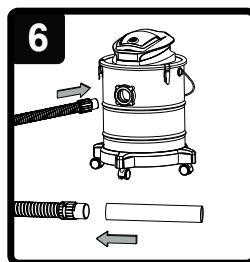
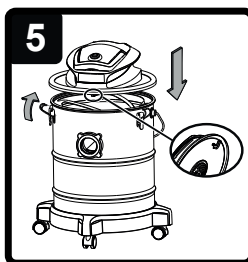
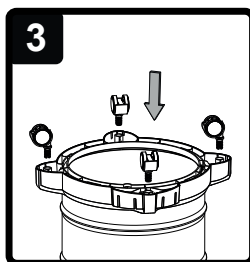
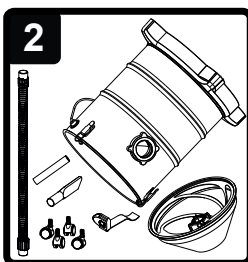
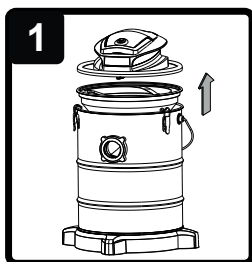



# LED WORK LIGHT USE

When vacuuming in a dark room or in the corner of a fireplace or stove, the LED Work Light can help shed some light on the work area.

Attach the LED Work Light to the crevice tool or wand with the included hook and loop strap, and switch it on when you need more light (Fig. 1 & 2).

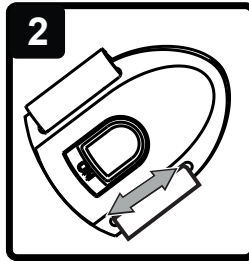
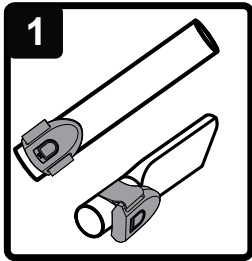

There are two replaceable button cell batteries in the LED Work Light. You can change them when the LED is turned off.

Use only a CR 2016 3V button cell battery with your LED Work Light.

Use a properly size of slotted screwdriver to open the battery cover.

1. Insert the screwdriver into the slot on both sides of battery cover and remove the battery cover (Fig. 1).
2. Carefully replace both button cell batteries with a new set of batteries (Fig. 2).
3. Close the cover by pressing the cover into the LED work light housing with proper force (Fig. 3).
4. Check if the battery cover is closed and the light turns on and off.

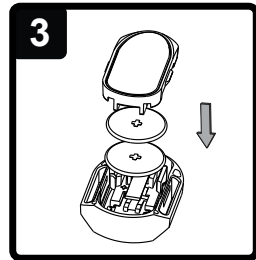
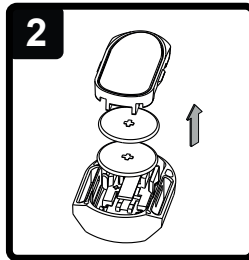
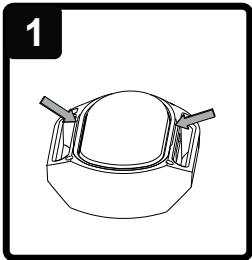

**CAUTION! THIS PRODUCT CONTAINS A BUTTON BATTERY. IF SWALLOWED, IT COULD CAUSE SEVERE INJURY OR DEATH IN JUST 2 HOURS. SEEK MEDICAL ATTENTION IMMEDIATELY!**

# ASH VACUUM OPERATION

1. Make sure all parts are in place.  
Never use ash vacuum without the filter in place.  
Never use ash vacuum without the metal nozzle or crevice tool in place.
2. Make sure the on/off switch is in the "O" (OFF) position (Fig. 1).
3. Plug the power cord into the outlet, then turn on the ash vacuum by flipping the switch to the "I" (ON) position (Fig. 2 & 3).
4. Run the unit for 30 seconds after you have finished cleaning your stove or fireplace to ensure all materials are safely captured in the collection tank.
5. Once you have finished vacuuming, flip the switch to the "O" (OFF) position and unplug the cord from the power outlet.

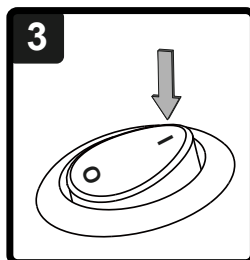
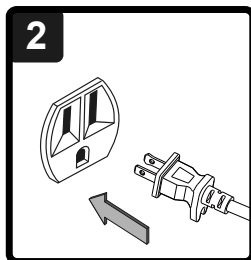
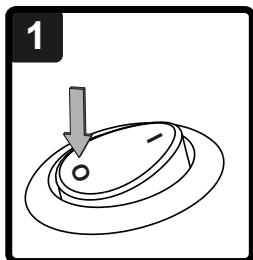

## POLARIZED PLUG

To reduce the risk of electrical shock, this ash vacuum has a polarized plug (one blade wider than the other). This plug will fit in a polarized outlet only one way. If the plug does not fit fully in the outlet, reverse the plug. If it still does not fit, contact a qualified electrician to install the proper outlet. Do not change the plug in any way. Double insulation  eliminates the need for the three wire grounded power cord and grounded power supply system.



**WARNING: BE SURE TO READ, UNDERSTAND, AND APPLY INFORMATION ENTITLED 'IMPORTANT SAFETY INSTRUCTIONS'. DO NOT VACUUM IN AREAS WITH FLAMMABLE GASES, VAPORS, OR EXPLOSIVE DUSTS IN THE AIR. FLAMMABLE GASES OR VAPORS INCLUDE BUT ARE NOT LIMITED TO: LIGHTER FLUID, SOLVENT TYPE CLEANERS, OIL-BASED PAINTS, GASOLINE, ALCOHOL, OR AEROSOL SPRAYS. EXPLOSIVE DUSTS INCLUDE BUT ARE NOT LIMITED TO: COAL, MAGNESIUM, GRAIN, OR GUN POWDER. TO REDUCE THE RISK OF HEALTH HAZARDS FROM VAPORS OR DUST, DO NOT VACUUM TOXIC MATERIALS.**

# BLOWER OPERATION

**This ash vacuum has blowing capabilities.**

**To use the blower feature follow the instructions listed.**

1. Insert the large end of the hose into the blower connection in the top of the motor housing (Fig. 1).
2. Ensure the on/off switch is turned to the "O" (OFF) position, then plug the power cord into the electrical outlet (Fig. 2).
3. Turn the motor on by flipping the switch to the "I" (ON) position (Fig. 3).
4. The unit will now blow through the vacuum hose. This can be used to clear obstructions in the hose, or to convert the vacuum to a blower (Fig. 4).

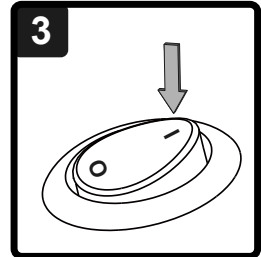
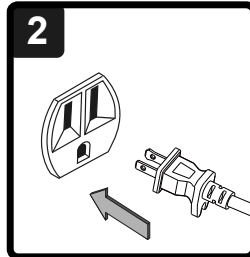
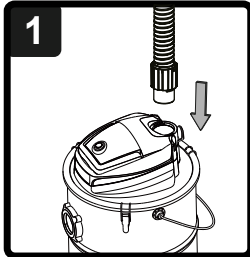

**WARNING: ALWAYS WEAR SAFETY GOGGLES BEFORE USING BLOWER. KEEP BYSTANDERS CLEAR FROM BLOWING DEBRIS. WEAR A DUST MASK IF BLOWING CREATES DUST THAT MIGHT BE INHALED.**

# MAINTENANCE

**⚠ WARNING: ALWAYS DISCONNECT THE PLUG FROM THE POWER OUTLET BEFORE REMOVING THE POWER HEAD FROM COLLECTION TANK.**

## REMOVING AND CLEANING THE FILTER

1. Verify that the power cord is disconnected from the outlet (Fig. 1).
2. Remove the power head (Fig. 2).
3. Carefully remove the filter from the collection tank (Fig. 3).
4. Clean the ash or dirt from the filter by gently tapping or brushing the ash or dirt off (Fig. 4).

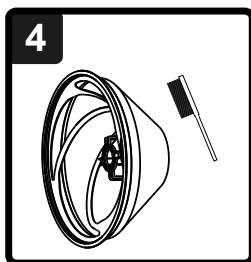
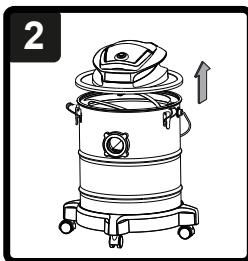
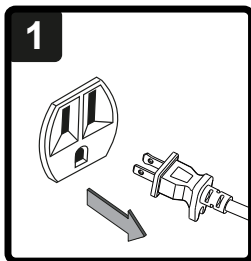

**IMPORTANT! CLEANING SHOULD NOT BE DONE INDOORS IN LIVING AREAS. FOR OPTIMAL PERFORMANCE A NEW FILTER IS RECOMMENDED.**

**NOTICE:** Only use manufacturer approved accessories and spare parts. The use of original accessories and original spare parts ensures that the ash vacuum can be operated safely.

# TROUBLESHOOTING



**WARNING: TO REDUCE THE RISK OF ELECTRIC SHOCK-UNPLUG BEFORE TROUBLE SHOOTING.**

Problem	Possible Cause	Solution
Vacuum will not operate.	No power supply.	Check power supply-cord, breakers, fuses.
	The filter is not installed correctly onto the micro-switch.	Check the filter assembly and make sure it is against the switch.
	Collection tank is full.	Empty the collection tank and clean or replace filters.
The dust comes out from the motor cover.	The filter is damaged or installed incorrectly.	Reinstall or replace the filter.
Reduced efficiency and motor/speed vibration.	There is a blockage in the hose, or the collection tank inlet. The ash filter is clogged by fine dust.	Check hose and collection tank inlets for blockage. Take off the filter and clean it. Or install a new ash filter.

# EXPLODED VIEW

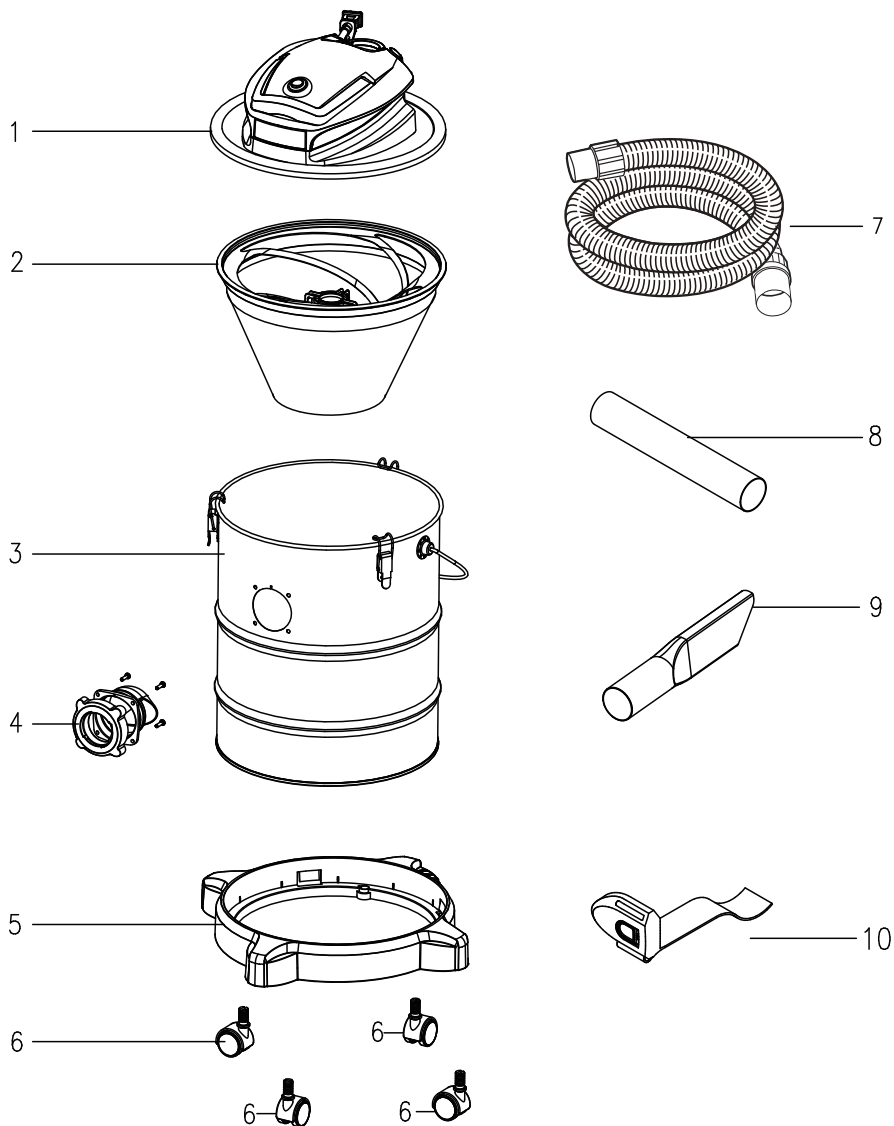

# PARTS LIST

Part	Part Number	Description	Quantity
1		Power Head Assembly	1
2	AVPF3	Ash Filter Assembly	1
3		Collection Tank	1
4	551163107	Vacuum Port Assembly	1
5	551038112	Base	1
6	551021122	Caster	4
7	551166105	Aluminum Hose	1
8	551104116	Aluminum Wand	1
9	551166106	Aluminum Crevice Tool	1
10	VLED	LED Work Light	1